

0.50 mm. FCC/FPC SIDE ENTRY ZIF SMT CON.



0519 SERIES. 0.50mm (0.020") Pitch.

General Features

- Available in 4 through 60 circuits
- Zero insertion force (ZIF) and high retention force
- Accept 0.30 mm thickness FPC
- Downside contact
- Easy for FPC installation and reliable operation
- With metal fixed SMT tabs to secure connector on PCB

Materials

- Body: High temperature plastic UL 94 V-0
- Slider: High temperature plastic UL 94 V-0
- Contact: Phosphor bronze; Fixed tab: Brass
- Operating temperature. -40°C to + 85°C
- RoHS compliant

Dimensional Information

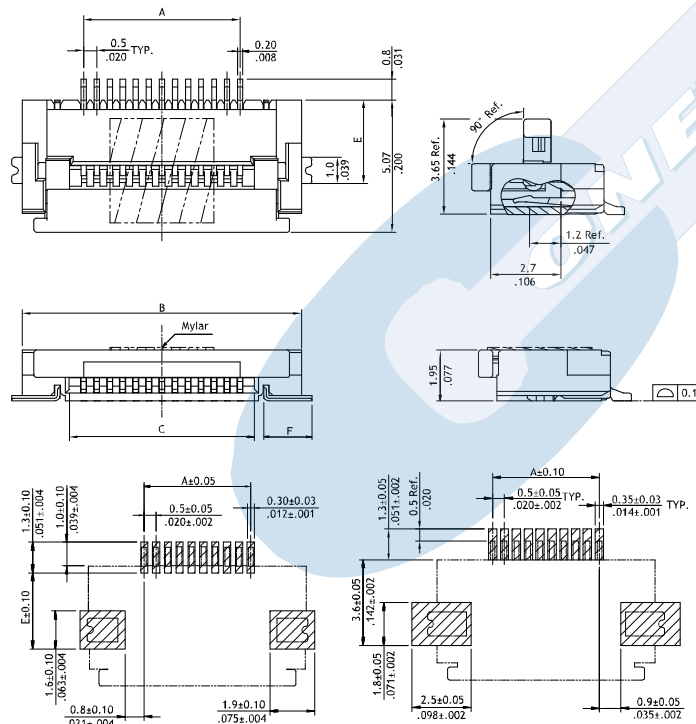

Recommended P.C. Board Layout
For finish E=0, 1, 2 and 3

Recommended P.C. Board Layout
For finish E=4 and 5

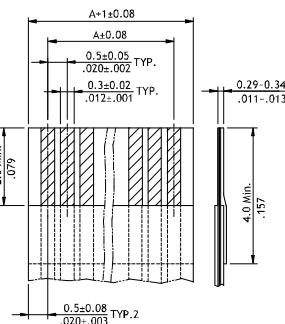
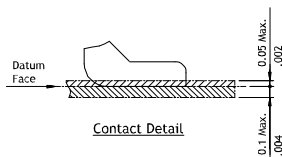

Accommodated FFC/FPC

Ordering Information:

0519 - 2- XX- 1- E
1 2 3 4

1. Connector Series

2. (T) Contact Plating

- T = 2. Tin plated

3. (XX) Number of circuits

- Available in 4 through 60 circuits

4. (E) Packing and Dimensions Options

- E = 0. Without Mylar , E=3.20 mm; F=1.50mm.
- E = 1. With Mylar , E=3.20 mm; F=1.50mm.
- E = 2. Without Mylar , E=2.85 mm; F=1.50mm.
- E = 3. With Mylar , E=2.85 mm; F=1.50mm.
- E = 4. Without Mylar , E=3.20 mm; F=1.85mm.
- E = 5. With Mylar , E=3.20 mm; F=1.85mm.



DIMENSIONS:

A = 0.5 x (xx-1)
B = 0.5 x (xx) + 4.20
C = 0.5 x (xx) + 0.60

*(XX) = Circuits (4 through 60)